



CALSENS

BUTTERFLY VALVES



TECHNICAL DATA SHEET

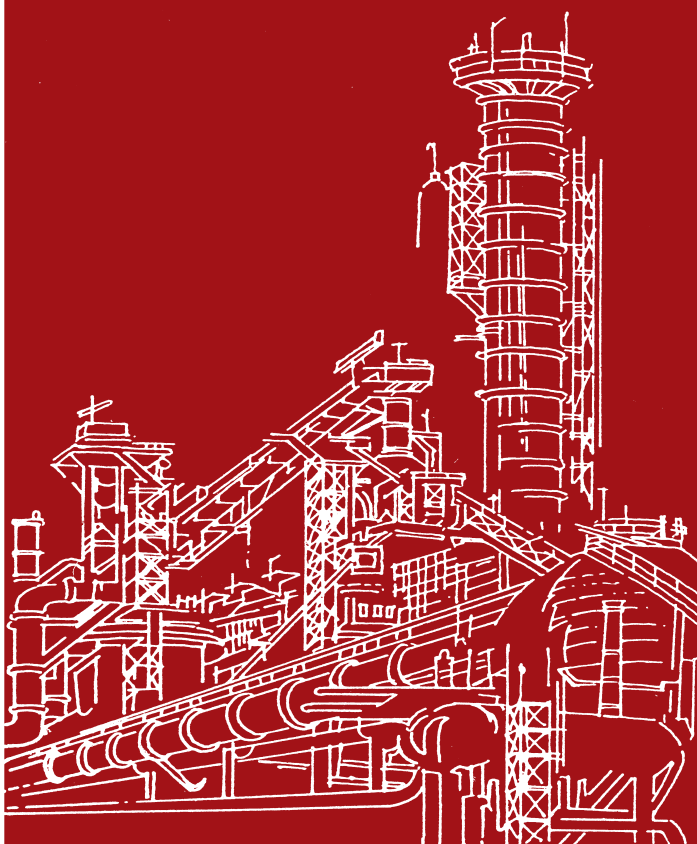



CALSENS Butterfly Valves are now a name to reckon among Engineers throughout the country. Each valve is specially tested under strict supervision and quality control, unique design, superb production and hard-gained field experience have made these valves reliable.

The construction features facilitate easier operation. Disc Shaft arrangement is of eccentric type, the drive from shaft is transmitted to the disc by means of key which is locked in position with grub screw. The design is such that the flow is uniform with minimum pressure drop.

Operation

1. Manual
2. Electric Actuator Operated
3. Pneumatic Actuator Operated

Standards

1. IS : 13095/91
2. As per AWWA C-504
3. As per BS-5155

Flanges Faced and drilled to IS : 1538, BS to TD/E, IS-6392. On demand drilling as per DIN, ANSI B 16.5 & undrilled possible.

The temperature range of tight shutt off valves is 20°C to 120°C. Temperatures upto 260°C are possible but the details of process fluid have to be considered before selecting the resilient Seal Material. Normally for Cast Iron Valves the maximum operating pressure is limited to 5 - 15 kg/cm² for valves upto 600 mm dia and to 10 kg/cm² for valves of higher sizes for higher pressure ratings valves can be supplied with MOC of SG Iron/Cast Steel. The maximum working pressure is limited by maximum operating temperature.

Butterfly valves are available in wafer type, flanged type short and long body.

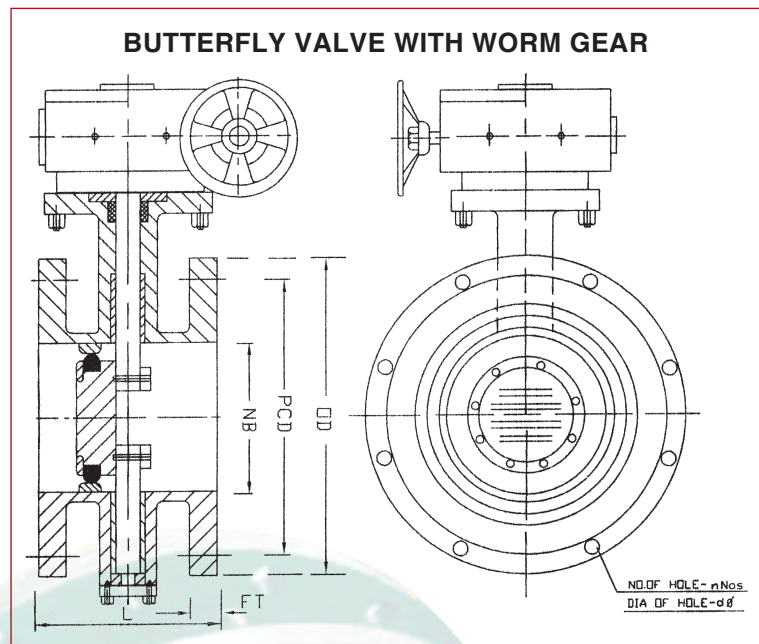

1800	2045	1970	79	44	43	1800	870	450	150	1670	1150
1700	1950	1865	74	44	43	1700	830	450	140	1560	1100
1600	1830	1760	69	40	43	1600	790	381	130	1490	1055
1500	1800	1710	61	40	43	1500	750	381	125	1320	980
1400	1630	1560	58	40	43	1400	710	381	120	1260	920
1300	1545	1470	55	32	40	1300	660	381	120	1190	850
1200	1455	1380	53	32	40	1200	630	381	100	1120	790
1100	1340	1270	50	32	37	1100	600	305	100	1030	685
1000	1230	1160	47	28	37	1000	550	305	95	975	640
900	1115	1050	44	28	34	900	510	305	90	925	585
800	1015	950	41.5	24	34	800	470	305	80	870	535
700	895	840	38.5	24	31	700	430	305	70	770	480
600	780	725	36	20	31	600	390	203	55	700	425
500	670	620	33	20	28	500	350	203	55	630	405
450	615	565	31.5	20	28	450	330	203	50	605	380
400	565	515	30	16	28	400	310	203	48	570	350
350	505	460	29	16	23	350	290	203	40	545	290
300	445	400	27.5	12	23	300	270	203	32	500	250
250	395	350	26	12	23	250	250	203	30	465	220
Valv Size NB	OD	PCD	T	n	d		ISS & BS	AWWA			
FLANGE DETAILS						L		d1	E	F	

Notes : All Dimensions are in mm unless stated otherwise

BUTTERFLY VALVE WITH ACTUATOR

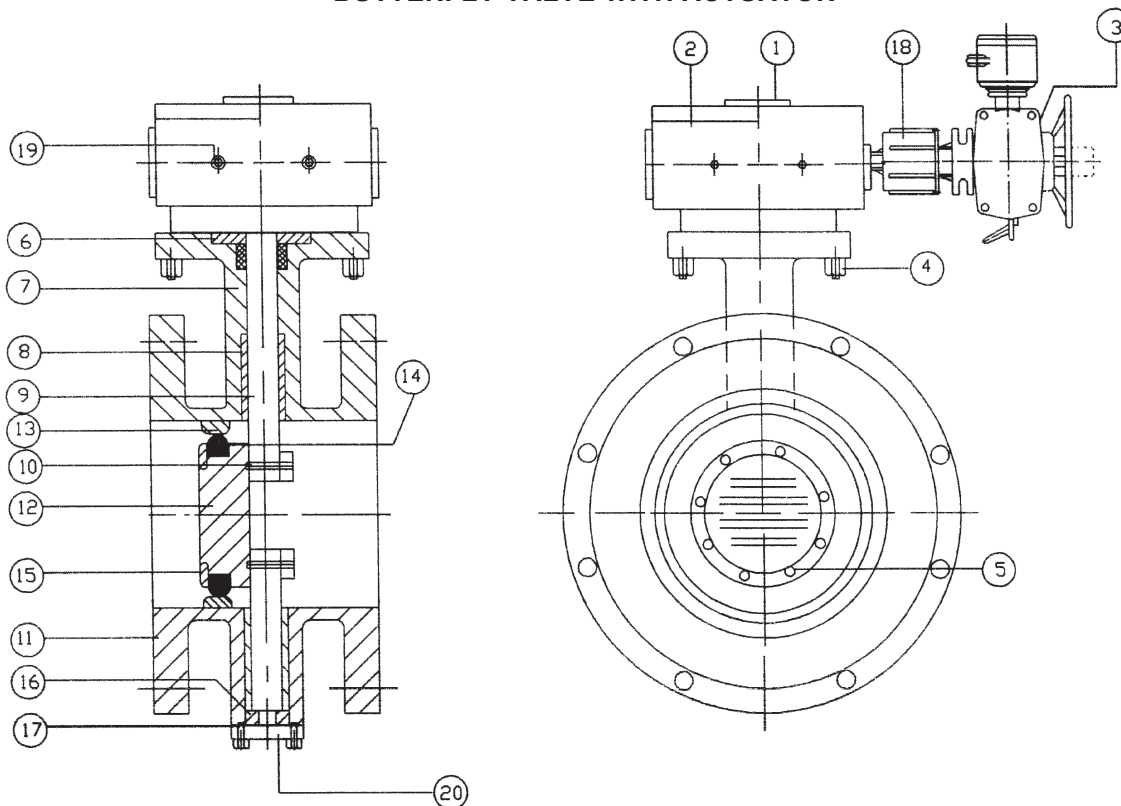

Materials of Construction

20.	COVER PLATE	CARBON STEEL	IS : 2062 GR A
19.	STOPPER BOLT	CARBON STEEL	IS : 1363
18.	SPUR GEAR BOX	CAST IRON	IS : 210 GR. FG - 200
17.	GASKET	RUBBER	IS : 638 Type - B
16.	THRUST BLOCK	LEADED TIN BRONZE	IS : 318 LTB - 2
15.	CLAMPING RING	STAINLESS STEEL	AISI 304
14.	DISC SEAL	RUBBER	EPDM
13.	BODY SEAT	STAINLESS STEEL	AISI : 304
12.	DISC	CAST IRON/CAST STEEL/SG IRON	IS : 210 Gr. FG-200/ASTMA 216 Gr. WCB/IS : 1865 GR. 500/7
11.	BODY	CAST IRON/CAST STEEL/SG IRON	AISI 304
10.	LOCKING PIN	STAINLESS STEEL	AISI 304
9.	SHAFT	STAINLESS STEEL	AISI : 410
8.	BUSH	LEADED TIN BRONZE	IS : 318 LTB-2
7.	SHAFT SEAL	RUBBER	EPDM
6.	SPACER	CARBON STEEL	IS : 2062 GR-A
5.	EXTERNAL HARDWARE	STAINLESS STEEL	AISI : 304
4.	EXTERNAL HARDWARE	CARBON STEEL	IS : 1363
3.	ELECTRIC ACTUATOR		
2.	WORM GEAR BOX	CAST IRON	IS : 210 GR. FG 200
1.	INDICATOR	CAST IRON	IS : 210 GR. FG 200
SL. NO.	DESCRIPTION	MATERIAL	SPECIFICATION

SILENT FUTURE

- ◆ Suitable for flow in either direction.
- ◆ Uniform Flow with minimum pressure drop.
- ◆ Hand lever operated.
- ◆ Worm Gear operation available for 150 mm and above sizes.
- ◆ Moulded rubber type or replaceable sleeve type available.
- ◆ Designed to fit without Gasket in between a wide variety of mating flanges.
- ◆ Valves are zero leakage bubble tight resilient seated.
- ◆ Pressure rating 16 bar.
- ◆ Temperature range - upto 80°C with Nitrile Rubber Seat and 120°C with EPDM Seat.

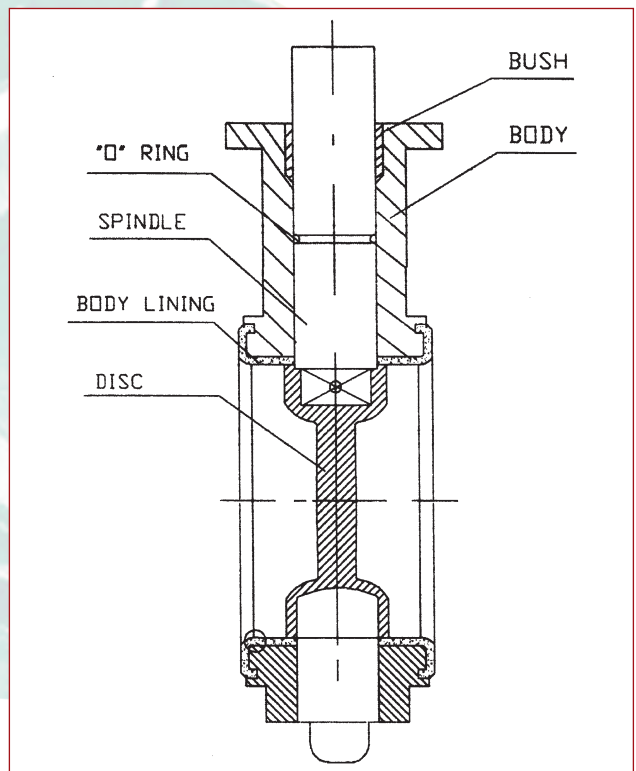

MATERIAL OF CONSTRUCTION

MOULDED TYPE

Sl.	Part List	Material	Specification
1.	Body	C.I.	IS : 210 FG 220
2.	Dice	C.I./Nylon Coated	-do-
3.	Valve Shaft	S.S.	AISI : 410
4.	Shaft 'O' Ring	Rubber	—
5.	Seating	Nitrile	Hand Lever
6.	Hand Lever	C.I./Fabricated	IS : 210/IS